

# 六角ホースニップルTK型

ステンレス製 SUS 304

## 大成トーツー型

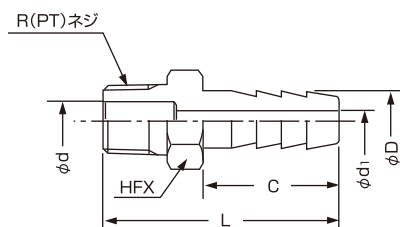
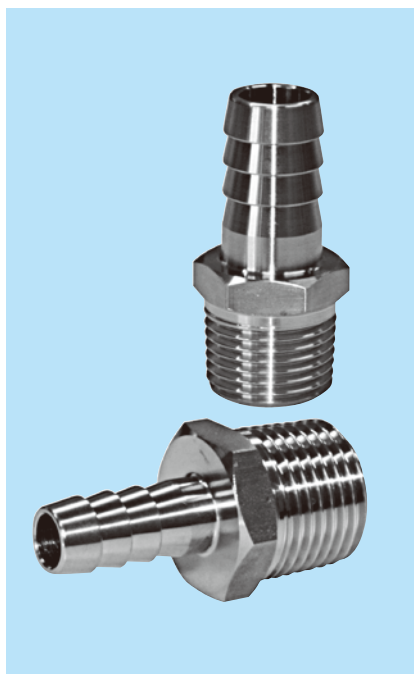

## 寸法表

型 式	R(PT)ネジ	φD	φd	φd <sub>1</sub>	L	C	HEX
TK-1-6	1/8"	6	5	3	31	17	12
TK-1-7	1/8"	7	5	4	31	17	12
TK-1-8	1/8"	8	5	4.5	33	19	12
TK-1-9	1/8"	9	5	5	33	19	12
TK-1-10.5	1/8"	10.5	6	6	33	22.5	12
TK-1-11	1/8"	11	6	6	33	22.5	12
TK-2-6	1/4"	6	7	3	33	17	14
TK-2-6.5	1/4"	6.5	7	3.5	33	17	14
TK-2-7	1/4"	7	7	4	33	17	14
TK-2-8	1/4"	8	7	4.5	40	24	14
TK-2-9	1/4"	9	7	5.5	40	24	14
TK-2-10.5	1/4"	10.5	7	7	40	24	14
TK-2-11	1/4"	11	8	7	40	24	14
TK-2-12.7	1/4"	12.7	8	8	45	29	14
TK-2-14	1/4"	14	8.5	8.5	45	29	14
TK-3-6	3/8"	6	9.5	3	36	18	17
TK-3-8	3/8"	8	9.5	4.5	43	24	17
TK-3-9	3/8"	9	9.5	5.5	43	24	17
TK-3-10	3/8"	10	9.5	6	44	25	17
TK-3-10.5	3/8"	10.5	9.5	7	44	25	17
TK-3-11	3/8"	11	9.5	7	44	25	17
TK-3-12	3/8"	12	9.5	8	44	25	17
TK-3-12.7	3/8"	12.7	9.5	8.5	44	25	17
TK-3-13	3/8"	13	9.5	8.5	44	25	17
TK-3-14	3/8"	14	9.5	9.5	44	25	17
TK-3-16	3/8"	16	11	11	44	25	17
TK-4-8	1/2"	8	12	4.5	45	23	22
TK-4-9	1/2"	9	12	5.5	45	23	22
TK-4-10	1/2"	10	12	6	45	23	22
TK-4-10.5	1/2"	10.5	12	7	45	23	22
TK-4-12	1/2"	12	12	8	49	27	22
TK-4-12.7	1/2"	12.7	12	8	49	27	22
TK-4-13	1/2"	13	12	8.5	49	27	22
TK-4-13.5	1/2"	13.5	12	9	49	27	22
TK-4-14	1/2"	14	12	9.5	49	27	22
TK-4-16	1/2"	16	12	11	49	27	22
TK-4-19	1/2"	19	14	14	53	31	22
TK-4-20.5	1/2"	20.5	15	15	53	31	22
TK-6-16	3/4"	16	19	11	55	29	27
TK-6-19	3/4"	19	19	14	58	32	27
TK-6-20.5	3/4"	20.5	20	15	58	32	27
TK-6-26	3/4"	26	20	20	65	39	27
TK-6-27	3/4"	27	20	20	65	39	27
TK-8-27	1"	27	25	20.5	70	40	35

●材質:SUS316、C3604、STEELは、ご用命によりお見積承ります。